

THE INFORMATION CONTAINED IN THIS DRAWING IS THE SOLE PROPERTY OF ELECTRO MECHANICAL INDUSTRIES, INC. ANY REPRODUCTION IN PART OR WHOLE WITHOUT THE WRITTEN PERMISSION OF ELECTRO MECHANICAL IND., IS PROHIBITED.

REVISIONS					
REV.	DCN #	DESCRIPTION	DATE	BY	APPROVED
8	01075	REVISED PART NO. 1002-0000-0013, UPDATED DETAIL A, UPDATED NOTES	8/30/2021	PCG	JPB

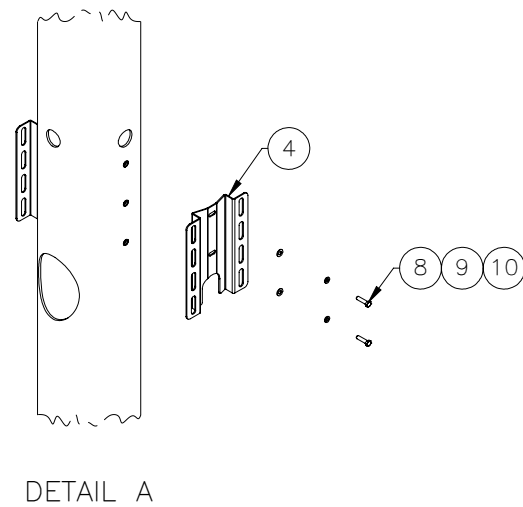
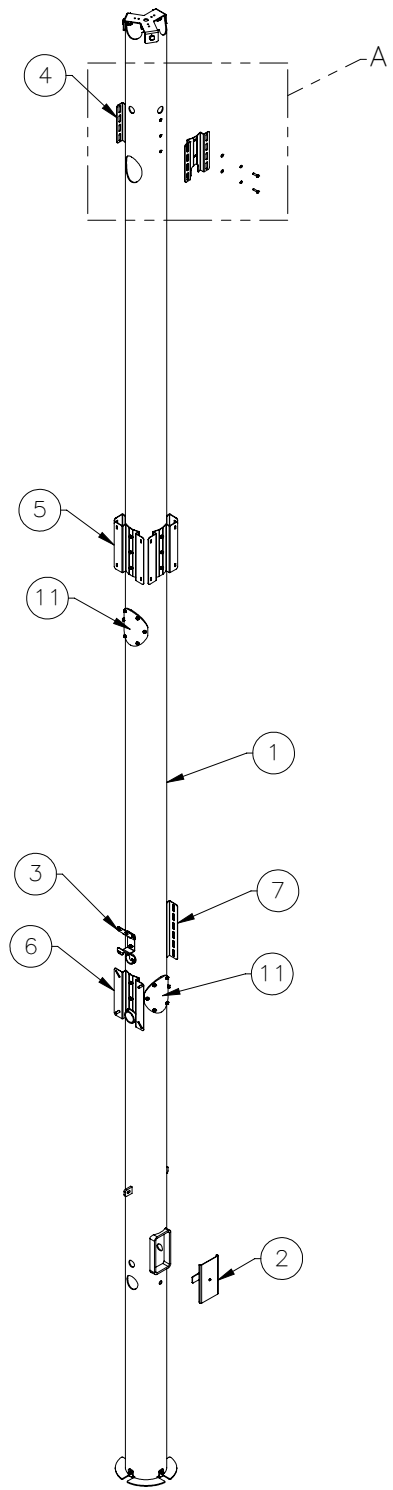
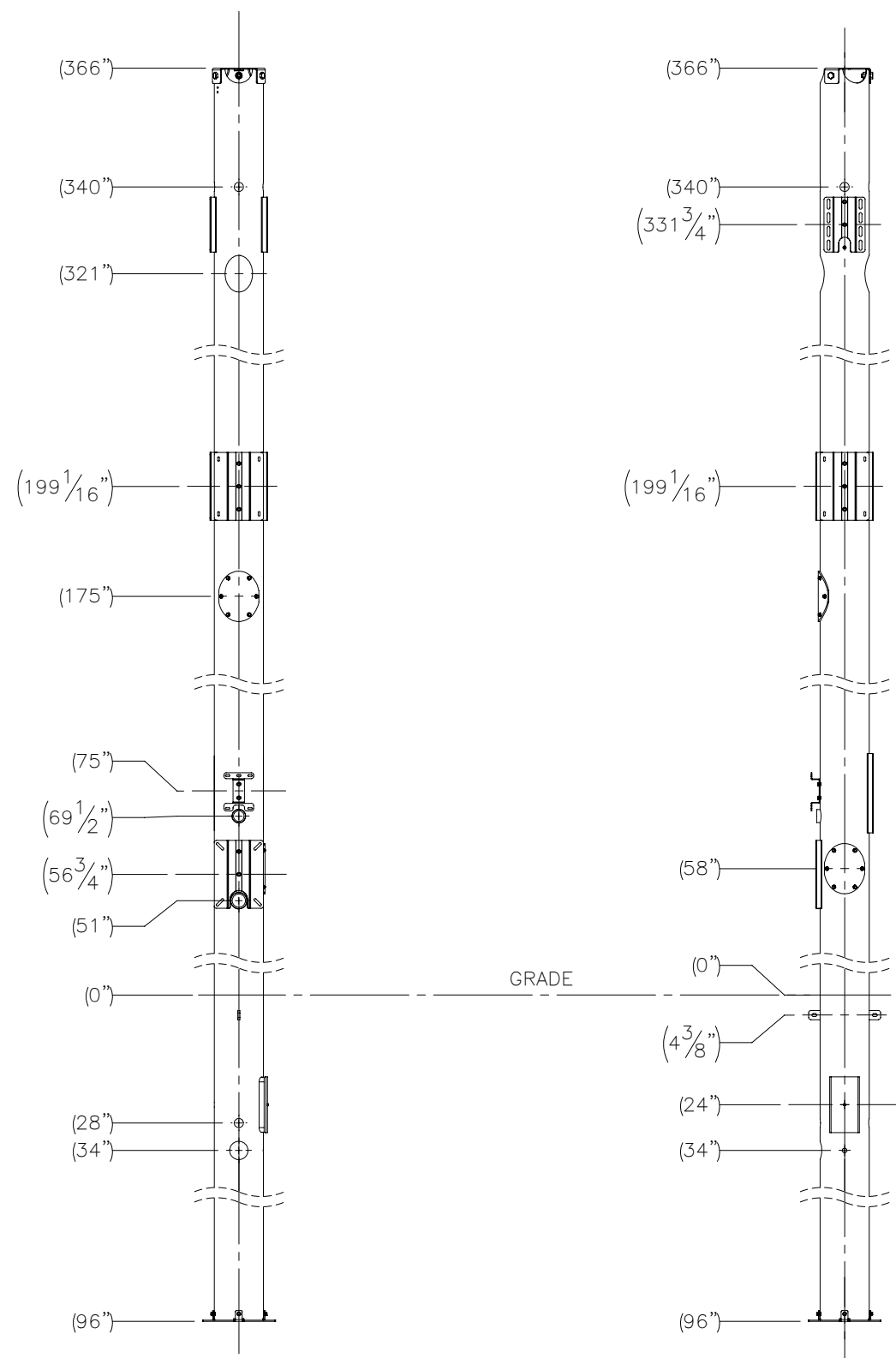

ITEM NO.	QTY REQD	PART NUMBER	DESCRIPTION	LENGTH	WEIGHT
1	1	1002-0000-0013	40'-11" BARE MONOPOLE		1091.4
2	1	1000-0020-0036	6" X 12" HANDHOLE COVER KIT		4.26
3	1	P-003-179	EQUIPMENT HAT, LOAD CENTER		1.3
4	2	P-003-314	EQUIPMENT HAT, CBRS RADIO, 10" PIPE		4.47
5	4	P-003-313	EQUIPMENT HAT, RECTIFIER, 10" PIPE		7.35
6	1	P-003-311	EQUIPMENT HAT, METER ENCLOSURE, 10" PIPE		6.75
7	1	P-003-310	EQUIPMENT HAT, CHARLES FIBER ENCLOSURE, 10" PIPE		7.48
8	34	002-0BZ-0052	BOLT, HEX, .375-16X 1.5 LG, GR 5, ZINC		0.01
9	34	002-0LW-G005	WASHER, SPLIT LOCK, .375 INCH, GALV.		0.01
10	34	002-0FW-G005	WASHER, FLAT, .375, GALV		0.01
11	2	P-003-433	COVER PLATE		8.6

NOTES:
 1. PAINT OR GALVANIZE PER CUSTOMER SPEC.
 2. TELECOM EQUIPMENT PROVIDED BY OTHERS

SURFACE FINISH <input checked="" type="checkbox"/> UNLESS OTHERWISE SPECIFIED		UNLESS OTHERWISE SPECIFIED DIMENSIONS ARE IN INCHES		APPROVALS		DATE		ELECTRO MECHANICAL INDUSTRIES, INC. 11230 NEESESHAW DRIVE HOUSTON, TEXAS 77065 1-800-453-0050	
MATERIAL SEE PARTS LIST		TOLERANCES .0 ±.06 .00 ±.015 .000 ±.005 FRACTIONS ± 1/16 ANGLES ± .25° HOLES: DRILLED OR PUNCHED ± 1/32 BURNED ± 1/32		DRAWN C. SANCHEZ 11/1/2018		DATE 11/1/2018			
THIRD ANGLE PROJECTION				CHECKER J. BREEN 11/16/2018		DATE 11/16/2018		SIZE B DRAWING NO. 1002-0020-0031 REV 8	
NEXT ASSY USED ON				ENGINEER J. BREEN 11/16/2018		DATE 11/16/2018			
APPLICATIONS				PRODUCTION J. SUNDERLAND 11/16/2018		DATE 11/16/2018			